

# ALPINE SHALLOW 2IN

## A1RC Extreme Shallow IC LED Housing



Round Downlight Trim Shown

Round Adjustable Trim Shown

Fixture Type:

Catalog Number:

Project:

Location:

### FINISHES



Black

Model

Finish

A1RC-268	New Construction IC-rated, Airtight	Black
----------	--	-------

Example: A1RC-268

### DESCRIPTION

ALPINE SHALLOW is a next level downlight, with an extreme-low profile that is designed to fit in tight plenum spaces without compromising lumen output or glare control. Choose from round or square, trim or trimless, and an array of finishes. With features such as vertical and horizontal adjustment. ALPINE SHALLOW is suitable for a wide range of applications including residential, commercial, hospitality and architectural.

### FEATURES

- IC rated extreme shallow plenum family
- Universal input voltage (120V-220V-277V)
- Downlight, Adjustable and Wall Wash Trims available
- Trim or trimless installation capable

### LINE DRAWING

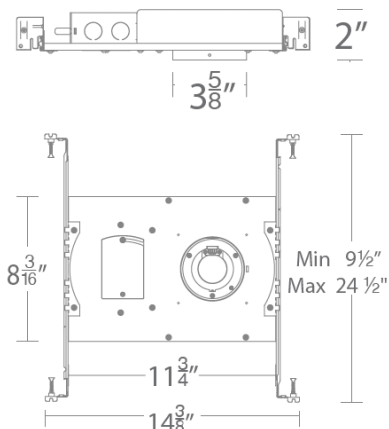

### SPECIFICATIONS

<b>Construction:</b>	Powder coated die cast aluminum
<b>Dimming:</b>	ELV, TRIAC, 0-10V (100% - 5%)
<b>Input:</b>	120V-277V AC
<b>Power:</b>	15W, power factor 0.98
<b>Cutout:</b>	Trim: 3 3/4"; Trimless: 4 1/8"
<b>Mounting:</b>	Retention clips firmly hold trim to housing.
<b>Finish:</b>	Powder coated black
<b>Standards:</b>	UL & cUL Listed, Airtight, Title 24 JA8-2016 Compliant
<b>Ceiling thickness:</b>	1/2" - 1"