

ALPINE SHALLOW 2IN

R1RC-A46 Round Adjustable Trim



Fixture Type:

Catalog Number:

Project:

Location:

FINISHES



White



Brushed Nickel

Model	Beam	Color Temp	CRI	Lumens	CBCP	Finish
A1RC-A46 (Round)	N 22°	27 2700K 30 3000K	90 90	1080 1120	2968 3078	BN Brushed Nickel WT White
	F 40°	27 2700K 30 3000K	90 90	1055 1095	1620 1680	BN Brushed Nickel WT White
Example: A1RC-A46N-27WT						

DESCRIPTION

Shallow housing that is designed to fit in tight plenum spaces without sacrificing lumen output.

FEATURES

- Designed to fit in tight plenum
- Wet location listed for trims
- 2" trim aperture, 2" housing height
- Universal input voltage (120V-277V)
- 5 year WAC Lighting product warranty
- 0-25° vertical and 365° horizontal adjustment

LINE DRAWING

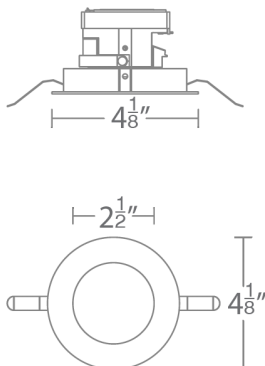

SPECIFICATIONS

Construction:	Die-cast aluminum trim with die-cast aluminum heat sink
Dimming:	100% - 5% with 0-10V 100% - 5% with Electronic Low Voltage (ELV)/ TRIAC
Input:	120V-277V AC
Power:	15W, power factor 0.98
Mounting:	Retention clips firmly hold trim to housing.
Finish:	Powder coated white, electroplated brushed nickel
Standards:	L & cUL Listed, wet location listed trims, Title 24 JA8-2016 Compliant
Ceiling thickness:	2" - 1"

aispire.com
Phone (800) 526.2588
Fax (800) 526.2585

Headquarters/Eastern Distribution Center
44 Harbor Park Drive
Port Washington, NY 11050

Central Distribution Center
1600 Distribution Ct
Lithia Springs, GA 30122

Western Distribution Center
1750 Archibald Avenue
Ontario, CA 91760

ALPINE SHALLOW 2IN

A1RC-268 *Housing*



Fixture Type:

Catalog Number:

Project:

Location:

FINISHES



Black

Model	Finish	
A1RC-268	New Construction IC-rated, Airtight	Black

Example: **A1RC-268**

LINE DRAWING

