

ALPINE RPS Basics

A2RH Downlight 4"



Fixture Type:

Catalog Number:

Project:

Location:

FINISHES



White

Model	Forward Voltage	Max.Drive Current	Max.# of Fixture	Beam	Color Temp	Lumens	CBCP	Finish
A2RH-446 (Round Remodel)	18V	550mA	2 per channel	F 45°	30 3000K	1035	1050	WT White
A2RH-246 (Round New Construction)								
A2RH-456 (Square Remodel)								
A2RH-256 (Square New Construction)								

Example: A2RH-456F-30WT

*AISPIRE RPS Required, Sold Separately

DESCRIPTION

Minimum profile downlight with driver and electrical connection box attached to fixture for easy remodel or new construction installation.

FEATURES

- Dimmable via AISPIRE RPS units, refer to RPS specifications for compatibility
- Electrical Box Located on back of fixture to allow easy installation
- Sold as remodel or new construction
- 5 year warranty

LINE DRAWING

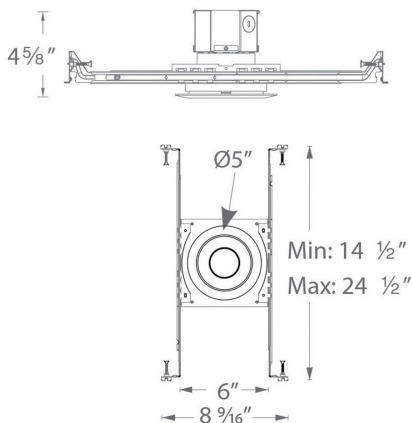

SPECIFICATIONS

Construction:	Die-cast Aluminum with 20 guage Cold Rolled Steel Junction Box
Power:	12W.
Input:	Class 2 Low Voltage, DC Power See fixture Configuration table above
Dimming:	Refer to RPS specifications for protocol and compatibility
Light Source:	Integrated LED
Lens:	Frosted TIR lens
Rated Life:	50000 Hours
Mounting:	Remodel Installation or New construction housing included with hanger bars
Cut Out:	4" for remodel, 4 1/8" for new construction
Finish:	Electrostatically Powder Coated White
Ceiling Thickness:	1/2" - 1 1/2"
Standards:	UL & cETL, Title 24 JA8-2016 Compliant, Wet location listed, IC, Airtight
Operating Temp:	-4°F to 104°F (-20°C to 40°C)

aispire.com
Phone (800) 526.2588
Fax (800) 526.2585

Headquarters/Eastern Distribution Center
44 Harbor Park Drive
Port Washington, NY 11050

Central Distribution Center
1600 Distribution Ct
Lithia Springs, GA 30122

Western Distribution Center
1750 Archibald Avenue
Ontario, CA 91760

AiSPiRE Remote Power Supply (RPS)

A2D LED DMX Power Unit



Model	# of channels	Finish
A2D20 2 x 75W Class 2 output DMX LED power unit	4	BK Black
A2D40 4 x 75W Class 2 output DMX LED power unit	8	BK Black

Example: A2D20-BK

FINISHES



Black

FEATURES

- 75W Max. Output Power (Per DMX Power Unit)
- 250mA-1500mA output current selection
- Class 2 power supply
- Built-in DMX512 interface
- IP20 rating
- UL Damp location listed

LINE DRAWING

A2D20 - 4 Channel

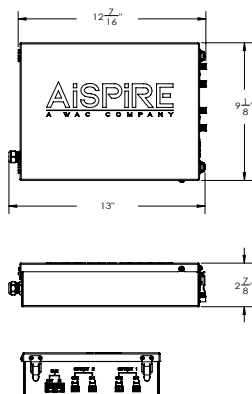

A2D40 - 8 Channel

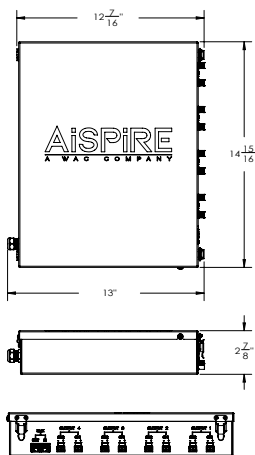

INPUT

Voltage Range:	120VAC
Frequency Range:	50/60Hz
Power Factor:	0.99 @100VAC
THD:	<15% @full load
Current:	0.9A @100VAC
Standby Power Consumption:	<0.5w

OUTPUT

LED Channels:	APD20-BK: 4 Channels APD40-BK: 8 Channels
Selectable Current:	250mA, 300mA, 350mA, 400mA, 450mA, 500mA, 600mA, 700mA, 800mA, 900mA, 1A, 1.1A, 1.2A, 1.3A, 1.4A, 1.5A
DC Voltage Range:	6-48VDC
Current Tolerance:	± 3%
Rated Power:	72W per channel 75W max (per 2-channel output)

CONTROL

Control Protocol:	DMX 512-A, DMX 512
Dimming Range:	0%-100%
Control Input:	DMX RJ45
Dimming Curve:	Linear/Logarithm (Selectable)

PROTECTION

Short Circuit, Over Voltage, Over Temp:	Recovers automatically after fault condition is removed
---	---

ENVIRONMENT

Ambient Operating Temp:	-4°F - 113°F (-20°C - 45°C)
-------------------------	-----------------------------

SAFETY & EMC

- Safety Standard: UL Damp Location
- EMC Emission: FCC Part 15 Class B
- Surge Immunity: Line-Line 1 kV

aispire.com
Phone (800) 526.2588
Fax (800) 526.2585

Headquarters/Eastern Distribution Center
44 Harbor Park Drive
Port Washington, NY 11050

Central Distribution Center
1600 Distribution Ct
Lithia Springs, GA 30122

Western Distribution Center
1750 Archibald Avenue
Ontario, CA 91760